

E3221WWNC- Elipta Navigator Mono - Copper - 12v - Warm White LED - Round

Description

E3221WWNC is a white LED deck and recessed light which consumes a tiny amount of power and stays cool to the touch, adding a stylish modern element to a garden lighting scheme. Navigator Mono are used to mark out the shape of a deck, patio or terrace, to outline paths and light small steps. To outline a deck or patio space with a distinctive shape, start at the corners of the decking or paving and space lights about 0.8 - 1.2 metres apart.



Electrical data	12v 0.5w 55lm 3000K. 1 metre 2 core HO5RN-F cable.
Colour/ Finish	Natural Copper top.
Exterior Dimensions	Top 50mm diameter. Body length 47mm. sleeve 41mm x 70mm.

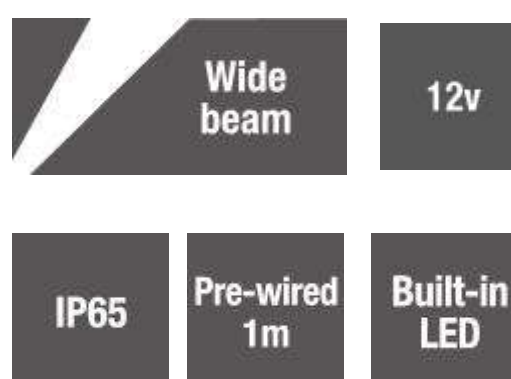

Installation guidelines

Navigator lights can be arranged in custom layouts using cable joint kits and 1.5mm cable, which is more flexible than kit-type products. Connect to the end of a low voltage cable using T9962 cable joint kit; for splicing into a run of cable use T9963 cable splice kit.

Do not use an electronic transformer to power Navigator LED lights. If powering from a 12v ac wire-wound transformer, ensure transformer is loaded to at least 75% of nominal rating.

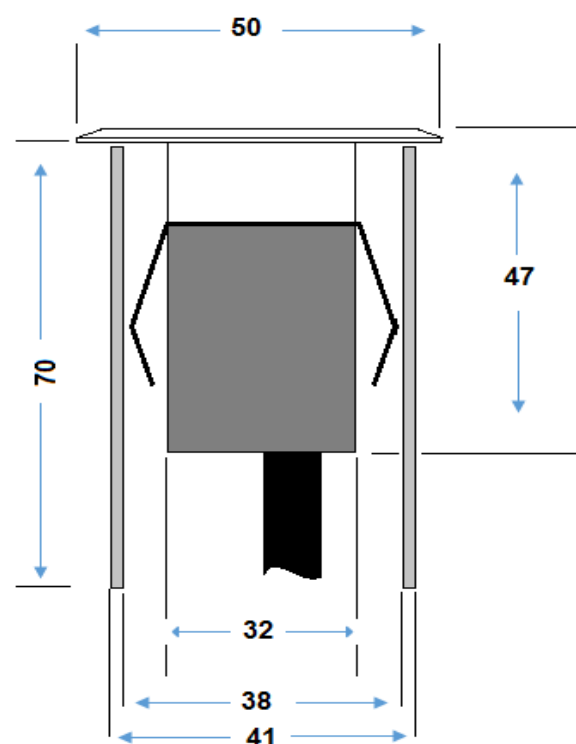

**2 YEAR
WARRANTY**

Exclusions: Damage by machinery, animals or the use of incorrect cleaning materials. Corrosion due to exposure to salt or chlorine. Damage due to incorrect installation practices. Responsibility for 3rd party cost; indirect or consequential loss